

# SB 302

---

## Hydraulic breaker

SB 302 from s/n BES043707



Units: Metric Imperial

Technical Specifications	
Carrier weight class	9900 - 19840 lb
Service weight **	670 lb
Oil flow	13 - 21 gpm
Operating pressure	1450 - 2175 psi
Impact rate	600 - 1400 blows/min
Working tool diameter	3.15 inch
Working length of tool	17.2 inch
Max. hydraulic input power	20 kW
Sound power level guaranteed	119 dB(A)
Sound pressure level (r=10m) ***	91 dB(A)

Units: Metric Imperial

Technical Specifications	
Carrier weight class	4.5 - 9 t
Service weight **	300 kg
Oil flow	50 - 80 l/min
Operating pressure	100 - 150 bar
Impact rate	600 - 1400 blows/min
Working tool diameter	80 mm
Working length of tool	440 mm
Max. hydraulic input power	20 kW
Sound power level guaranteed	119 dB(A)
Sound pressure level (r=10m) ***	91 dB(A)



## ■ BREAKERS

	Hitting power*	Blows/min	Weight
<b>SB 52</b>	101 J/Nm	960 – 1 700	55 kg/121 lbs
<b>SB 152</b>	254 J/Nm	840 – 1 900	140 kg/309 lbs
<b>SB 202</b>	406 J/Nm	850 – 1 800	200 kg/441 lbs
<b>SB 302</b>	610 J/Nm	600 – 1 400	310 kg/683 lbs
<b>SB 452</b>	855 J/Nm	550 – 1 250	441 kg/972 lbs
<b>SB 552</b>	1 048 J/Nm	650 – 1 150	520 kg/1 146 lbs

Working tools Working tools SB 302

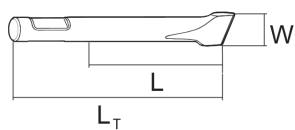
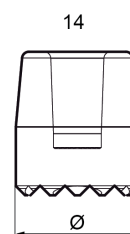
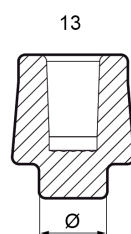
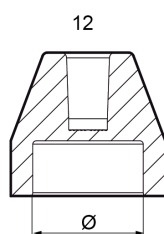
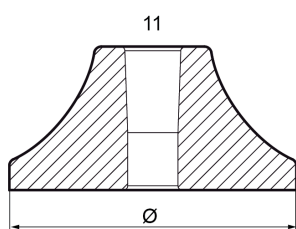
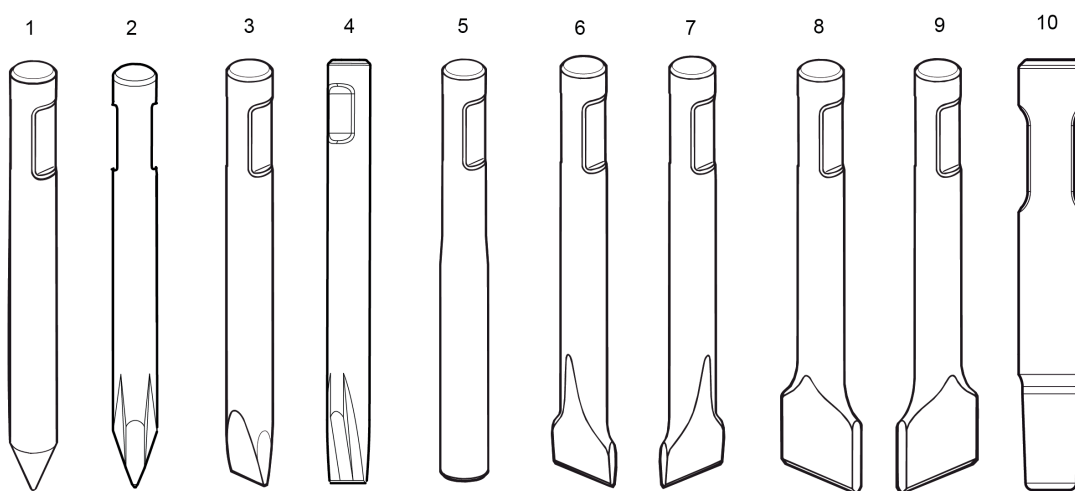

Item	Part No.	Name	Qty	L
1	3083 3191 00	Moil point	1	A
1	3083 3191 01	Moil point	1	B
2	3363 0982 54	Moil point (X-Profile)	1	C
3	3083 3192 00	Chisel (cross)	1	D
3	3083 3192 01	Chisel (cross)	1	E
4	3363 0982 55	Chisel (X-profile)	1	F
5	3083 3195 00	Blunt tool	1	G
6	3083 3194 00	Wide chisel (parallel)	1	H
7	3083 3193 00	Wide chisel (cross)	1	I
8	3083 3409 44	Asphalt cutter (cross)	1	J
9	3083 3409 45	Asphalt cutter (parallel)	1	K
10	3315 3703 00	Shaft	1	L
11	3315 3709 00	Tamping pad (square)	1	M
12	3315 3717 00	Post driver pad (round)	1	N
13	3315 3723 00	Pile driver pad (round)	1	O
14	3315 3730 00	Bushing pad (round)	1	P

Comments for Page: Working tools SB 302

(L)OCAL REMARKS

A | L=420 mm, LT=800 mm, Wt=28 kg

L=16.54 inch, LT=31.50 inch, Wt= 61.7 lb

B | L=620 mm, LT=1000 mm, Wt=35 kg

L=24.42 inch, LT=39.37 inch, Wt=77.2 lb

C | L=420 mm, LT=800 mm, Wt=26 kg

L=16.54 inch, LT=31.50 inch, Wt= 57.3 lb

D | W=80 mm, L=420 mm, LT=800 mm, Wt=28 kg

W=3.15 inch, L=16.54 inch, LT=31.50 inch, Wt= 61.7 lb

E | W=80 mm, L=620 mm, LT=1000 mm, Wt=36 kg

W=3.15 inch, L=24.41 inch, LT=39.37 inch, Wt=79.4 lb

F | W=80 mm, L=420 mm, LT=800 mm, Wt=27 kg

W=3.15 inch, L=16.54 inch, LT=31.50 inch, Wt= 59.5 lb

G | L=420 mm, LT=800 mm, Wt=30 kg

L | W=16.54 inch, LT=31.50 inch, Wt= 66.1 lb

H | W=150 mm, L=390 mm, LT=770 mm, Wt=26 kg

W=5.91 inch, L=15.35 inch, LT=30.31 inch, Wt= 57.3 lb

I | W= 150 mm, L=390 mm, LT=770 mm, Wt=26 kg

W=5.91 inch, L=15.35 inch, LT=30.31 inch, Wt= 57.3 lb

J | W=200 mm, L= 420 mm, LT=720 mm, Wt=27 kg

W=7.09 inch, L=16.54 inch, LT=28.35 inch, Wt= 59.5 lb

K | W=200 mm, L= 420 mm, LT= 720 mm, Wt= 27 kg

W=7.09 inch, L=16.54 inch, LT=28.35 inch, Wt= 59.5 lb

L | LT= 600 mm, Wt=15 kg

LT=23.62 inch, Wt= 33.1 lb

M | W= Ø300 mm, Wt=33 kg

W= Ø11.81 inch, Wt=72.8 lb

N | W=Ø150 mm, Wt=21 kg

W= Ø5.90 inch, Wt=46.3 lb

O | W=Ø100 mm, Wt=9 kg

W= Ø3.94 inch, Wt=19.8 lb

P | W=Ø130 mm, Wt=9,8 kg

W= Ø5.12 inch, Wt=21.6 lb

---

**Dimensions** Dimensions (mm)

